

STANDARD KERB DETAIL
SCALE 1:25

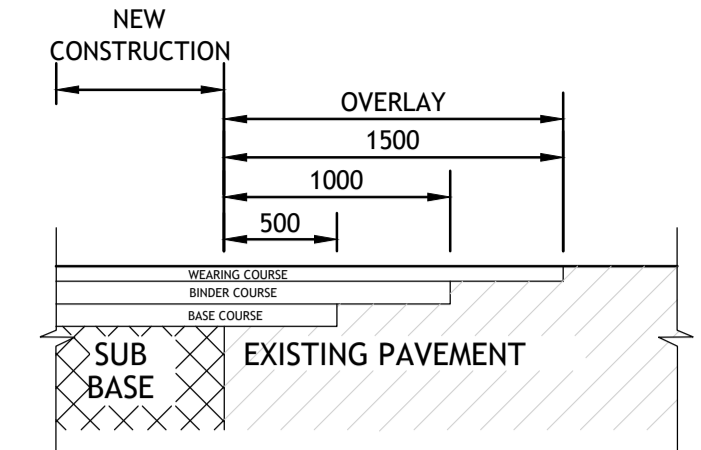

TRANSITION DETAIL
NOT TO SCALE

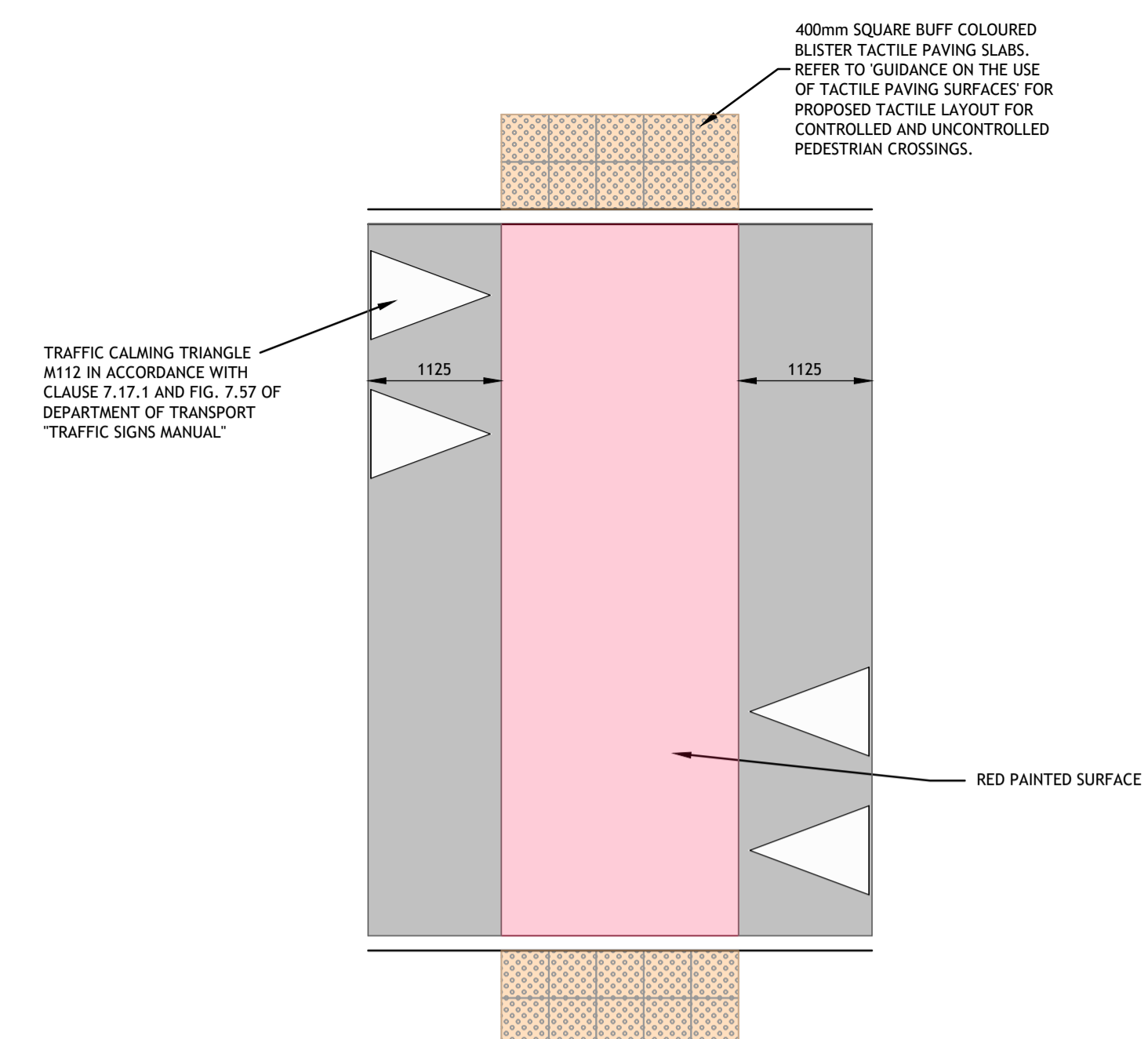

RAMP / UNCONTROLLED PEDESTRIAN CROSSING - PLAN
SCALE 1:50

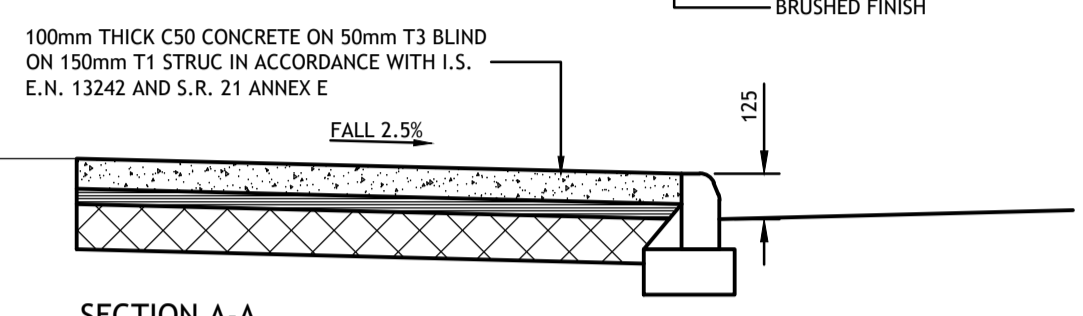

SECTION A-A
SCALE 1:25

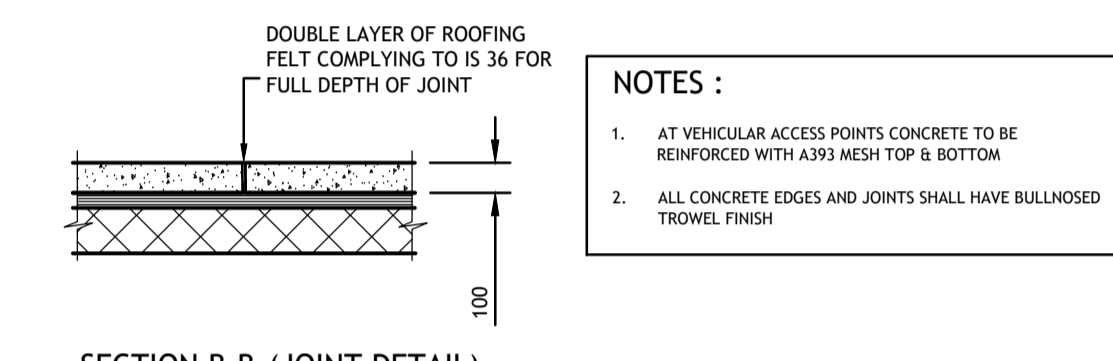

SECTION B-B (JOINT DETAIL)
SCALE 1:25

PLAN - CONCRETE FOOTPATH
SCALE 1:25

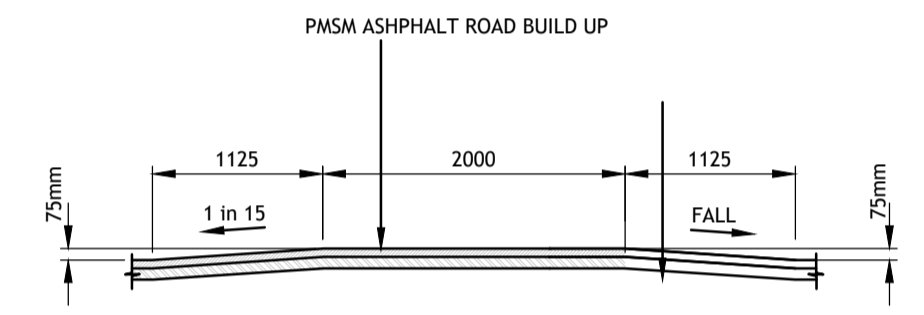

RAMP / UNCONTROLLED PEDESTRIAN CROSSING - TYPICAL SECTION
SCALE 1:50

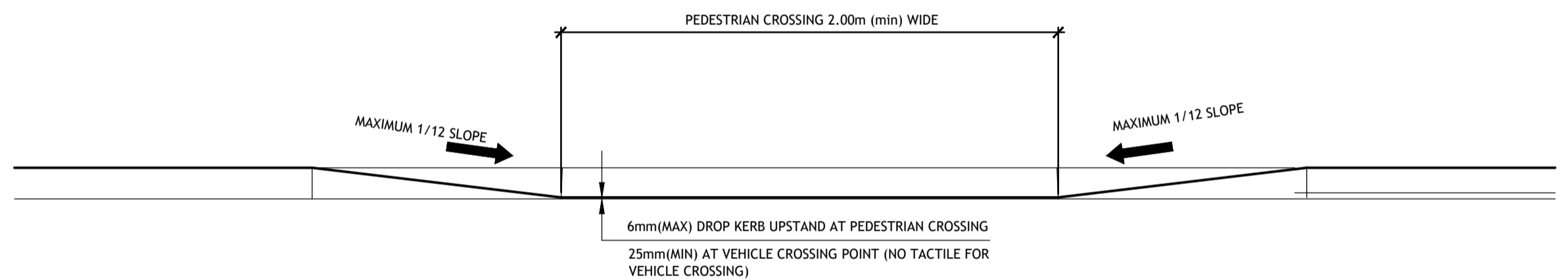

TYPICAL ELEVATION OF DROPPED KERB (DK)
SCALE 1:20

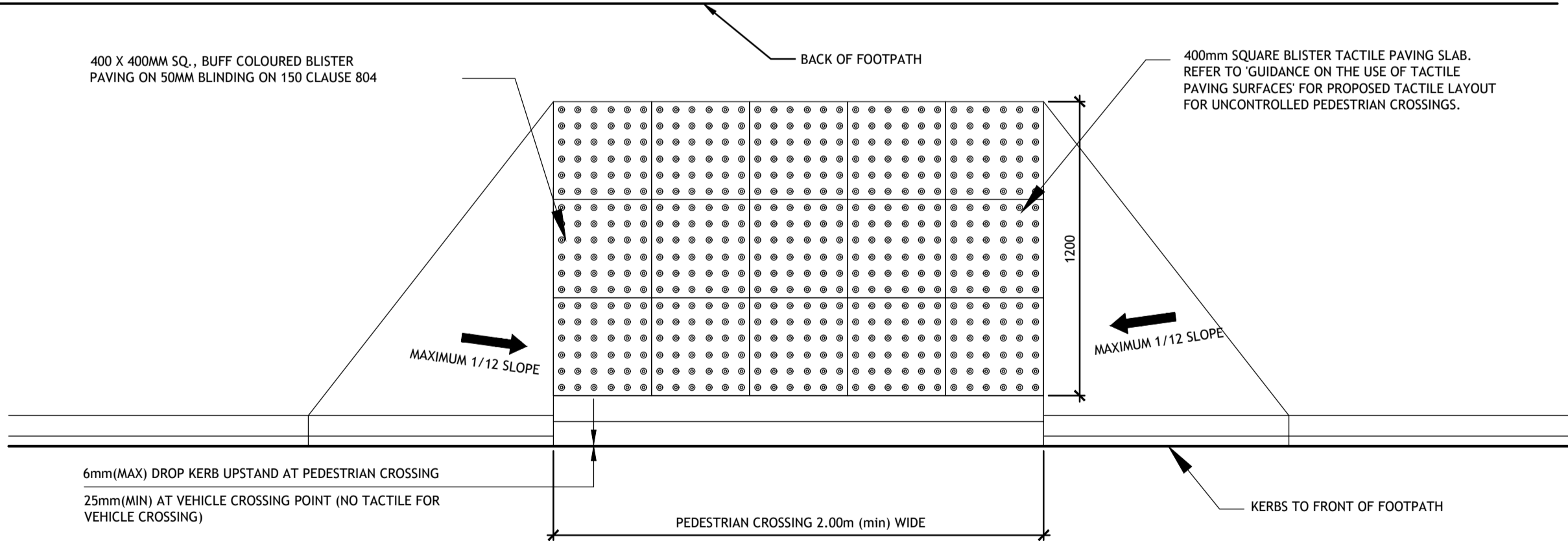

TYPICAL PLAN OF DROPPED KERB (DK)
SCALE 1:20

Rev	Amendment	By	Date	Rev	Amendment	By	Date
C01	ISSUE FOR PLANNING	IBS	2021/09/14				
C02	ISSUE FOR PLANNING	RD	2022/06/27				

Rev	Amendment	By	Date	Rev	Amendment	By	Date

Client:
DSPL Ltd.

Project: RATHGOWAN RESIDENTIAL DEVELOPMENT			
Title: TYPICAL CIVIL DETAILS - SHEET 5			
Drawn: RD	Date drawn: AUG 2021	Technician Check: IBS	Engineer Check: SO
Approved: PC			
Project No: 202215	Model No: 202215-PUNCH-XX-XX-M2-0500	Drawing Status: A0 PLANNING	
Scale @ A1: AS SHOWN	Document No: 202215-PUNCH-XX-XX-DR-C-0504	Revision No: C02	